



Metal America[®]
Roofing & Siding

Trim Profiles —

1.75" SNAP LOCK

1-855-METALUS
(638-2587)

WWW.METALAMERICA.COM

SALES@METALAMERICA.COM

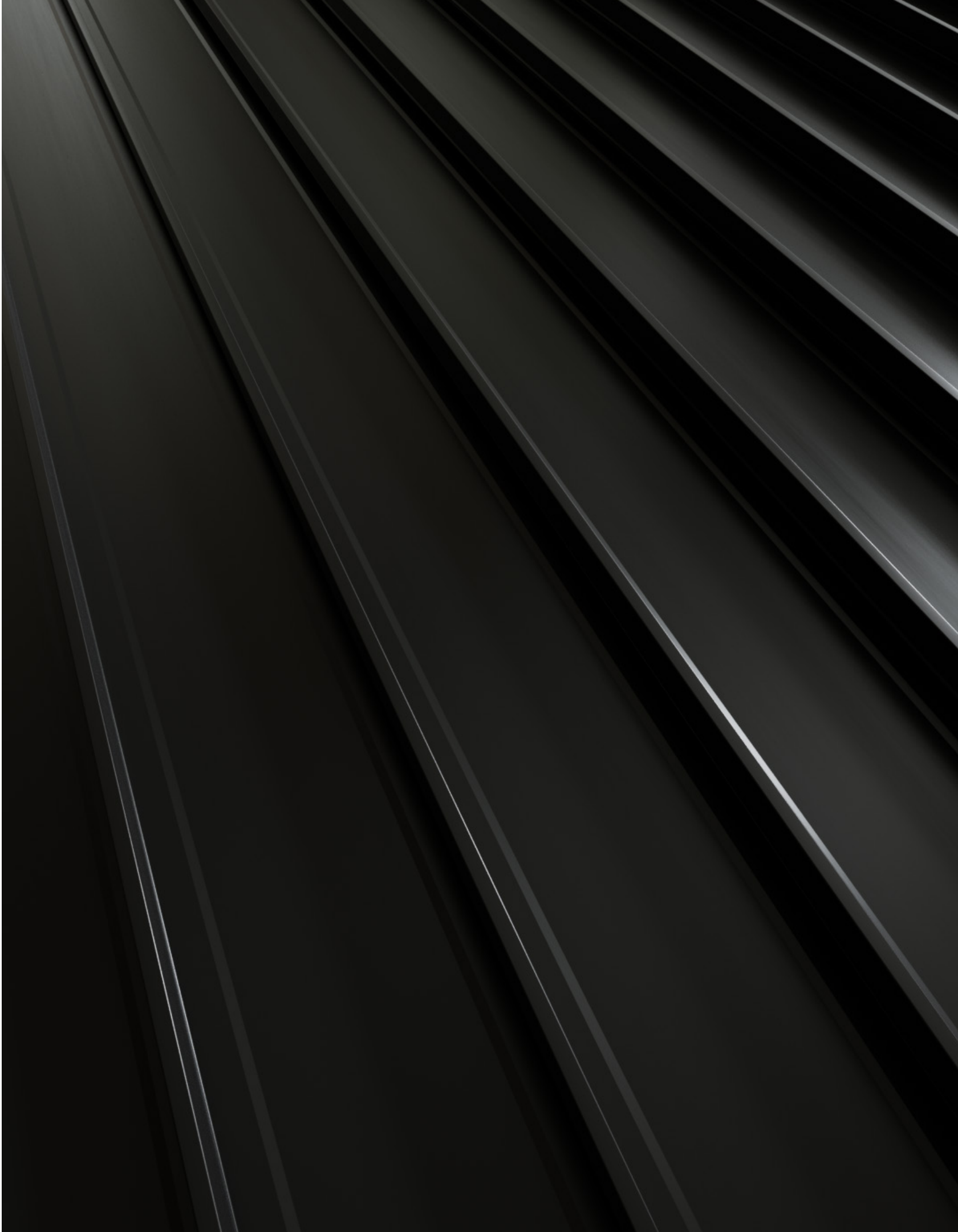

1.75" Snap Lock

Locking Outside Corner

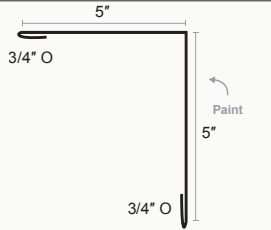

Locking Inside Corner

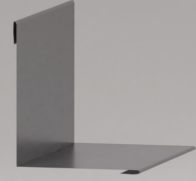
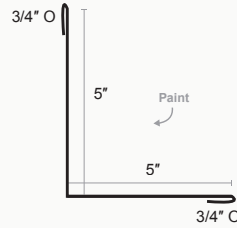

Style G Drip

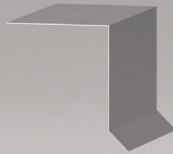
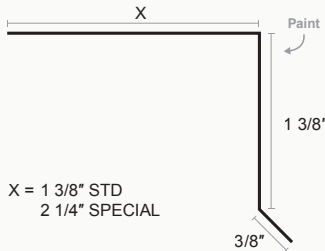

Eave Flashing

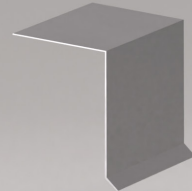
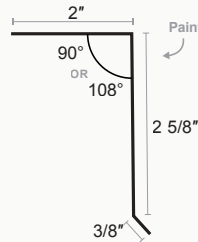

Style D

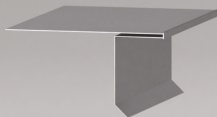
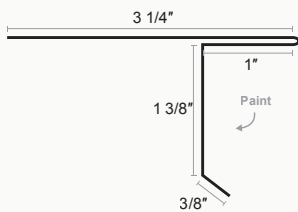

Bull Nose Eave

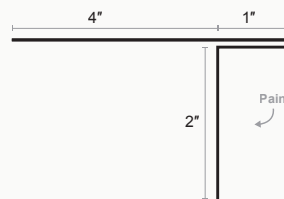

Standing Seam Rake A

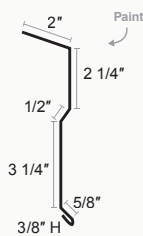

Drip Flashing

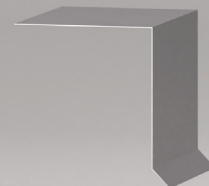
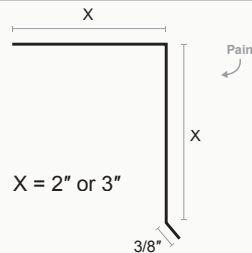

1.75" Snap Lock

Standing Seam Locking Peak Cap

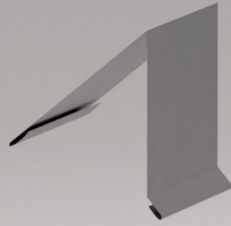
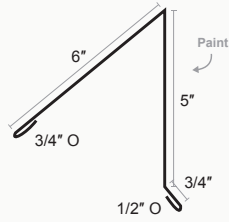

Fascia Trim

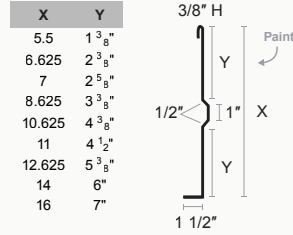

Standing Seam Side Wall

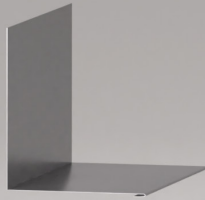
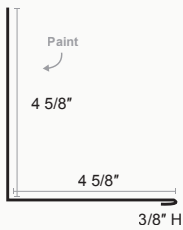

Locking Side Wall Flashing

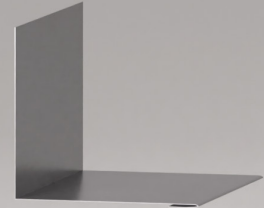
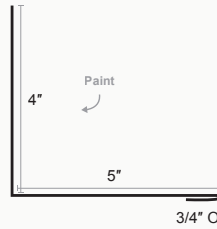

Standing Seam Locking Gable

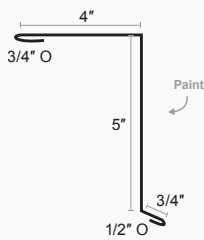

Standing Seam Box Gable_1.75

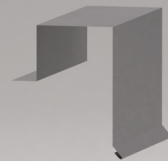
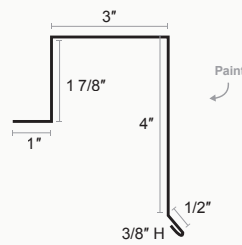

Standing Seam End Wall

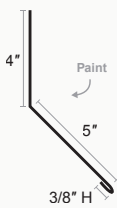

Locking End Wall Flashing

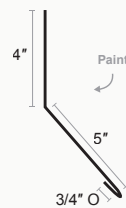

1.75" Snap Lock

Open Jamb

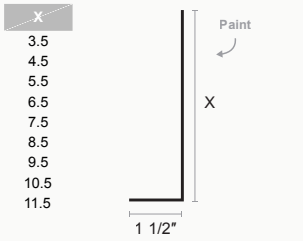

Offset Cleat

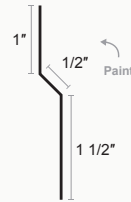

Standing Seam Raised Cleat



Z Bar_1.75

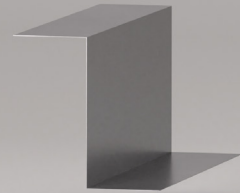
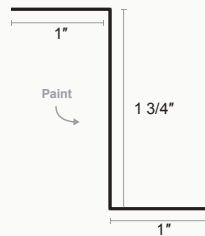

Standing Seam Locking Pitch Break

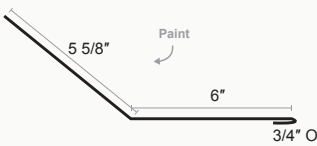

Standing Seam Locking Pitch Break Reverse

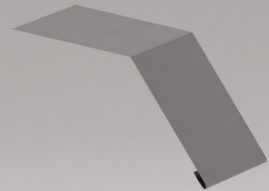
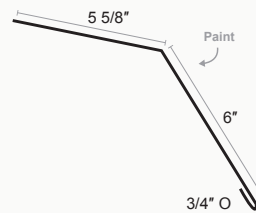

Chimney Flashing

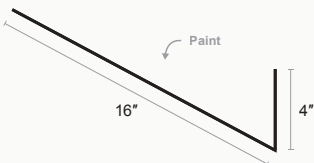

Standing Seam Ridge Valley



TRIM PROFILES

1.75" Snap Lock

Ridge Cap

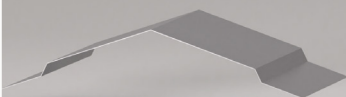
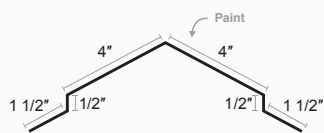

Standing Seam Locking Ridge Cap

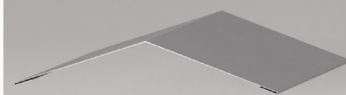
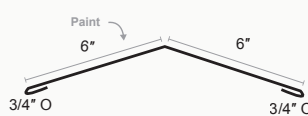

SnapZ Vented Z Bar

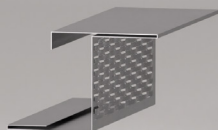
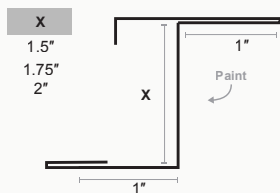

1" 1" X X

Paint

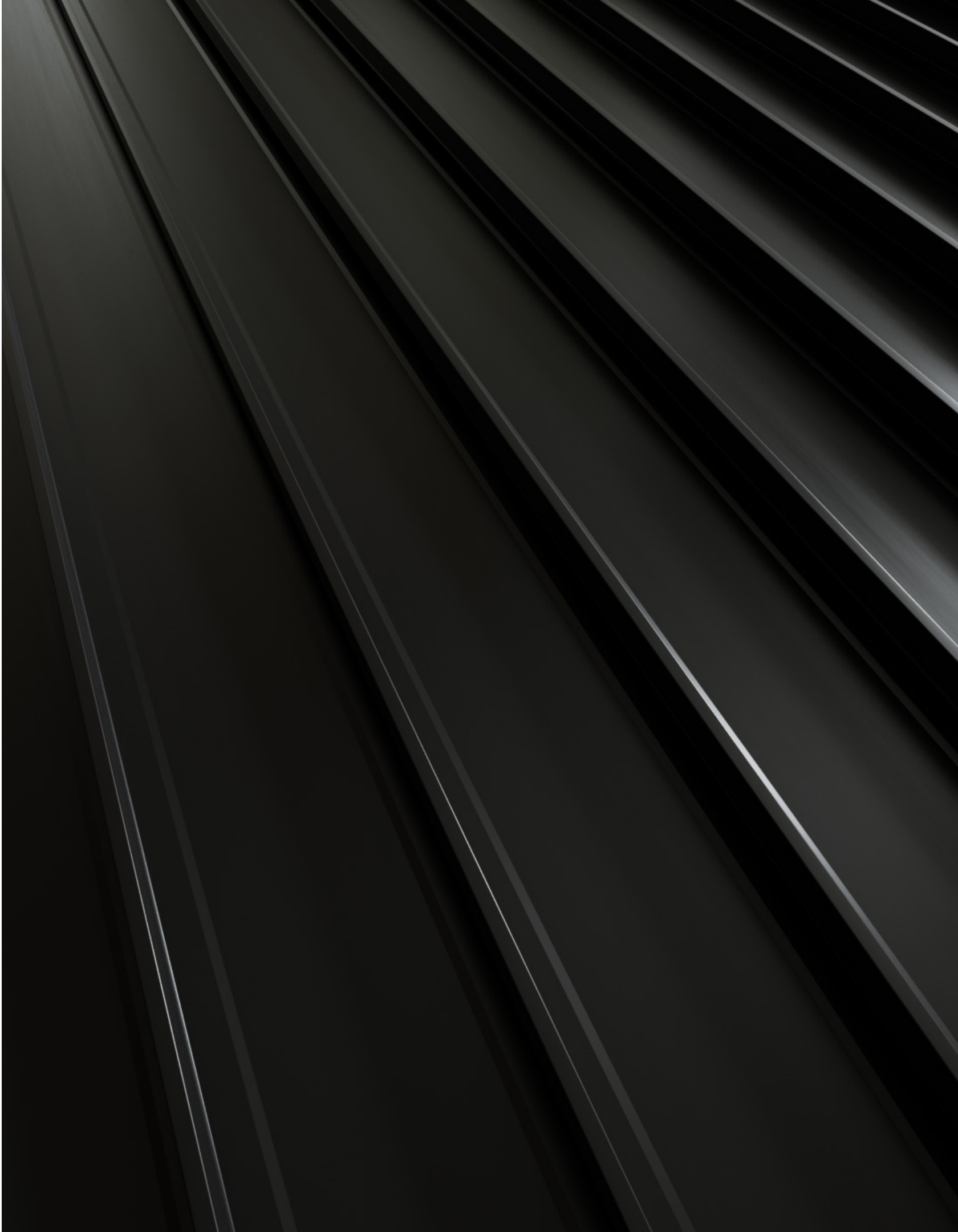



Metal America[®]
Roofing & Siding