



Metal America[®]
Roofing & Siding

Trim Profiles —

1.5" SNAP LOCK

1-855-METALUS
(638-2587)

WWW.METALAMERICA.COM

SALES@METALAMERICA.COM



1.5" Snap Lock

Locking Outside Corner

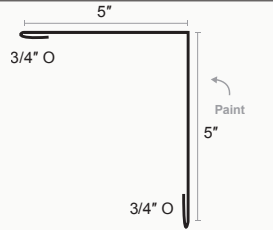

Locking Inside Corner

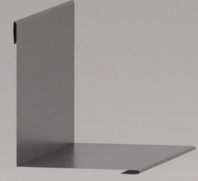
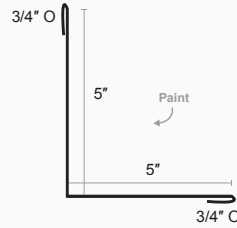

Eave Flashing

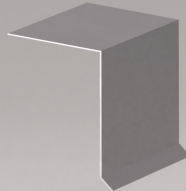
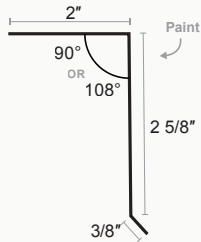

Style G Drip

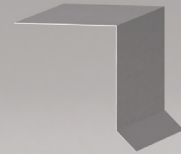
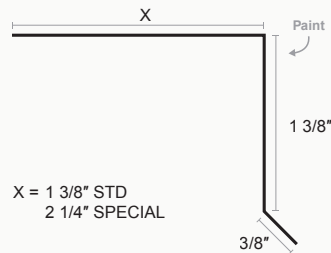

Bull Nose Eave

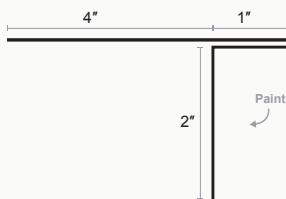

Style D

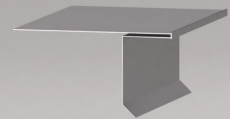
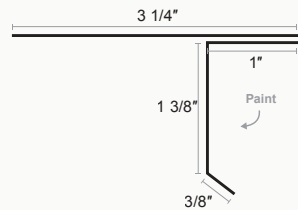

Z Bar_1.5

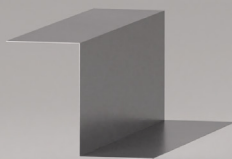
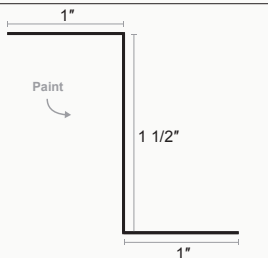

SnapZ Vented Z Bar

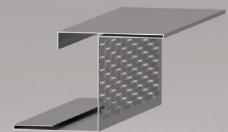
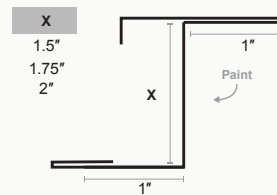

1.5" Snap Lock

Drip Flashing

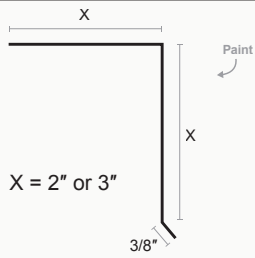

$X = 2"$ or $3"$

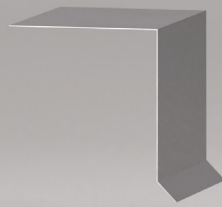

Standing Seam Locking Peak Cap

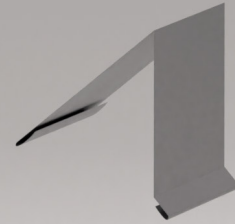
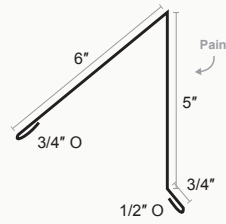

Fascia Trim

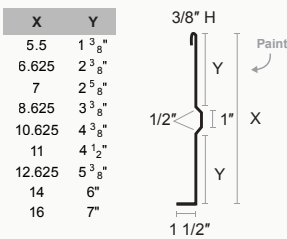

Standing Seam Side Wall

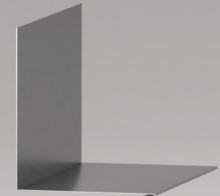
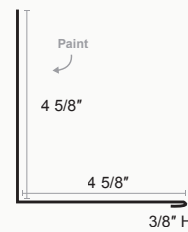

Locking Side Wall Flashing

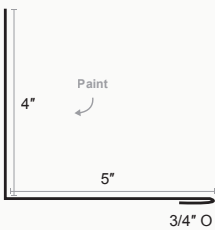

Standing Seam Locking Gable

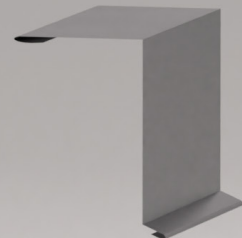
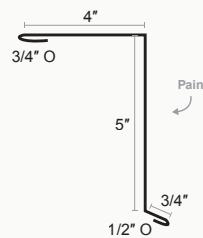

Standing Seam End Wall

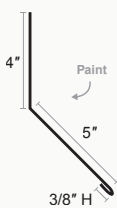

Open Jamb

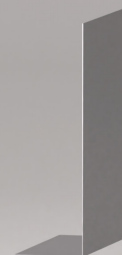
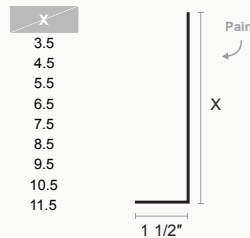

1.5" Snap Lock

Locking End Wall Flashing

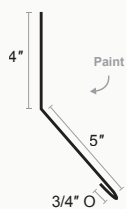

Standing Seam Raised Cleat



Offset Cleat

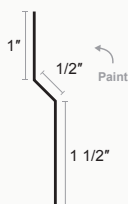

Standing Seam Rake A

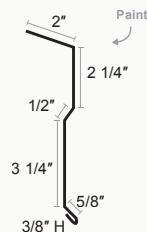

Standing Seam Locking Pitch Break

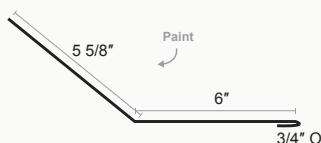

Standing Seam Locking Pitch Break Reverse

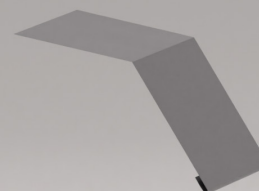
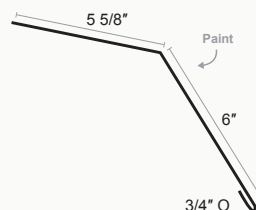

Standing Seam Locking Gable

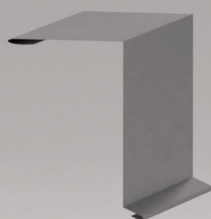
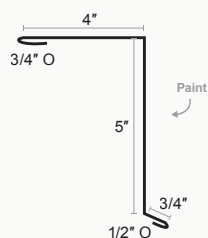

Chimney Flashing

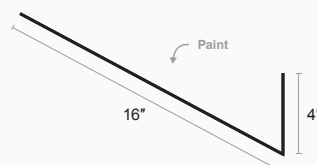

TRIM PROFILES

1.5" Snap Lock

Ridge Cap

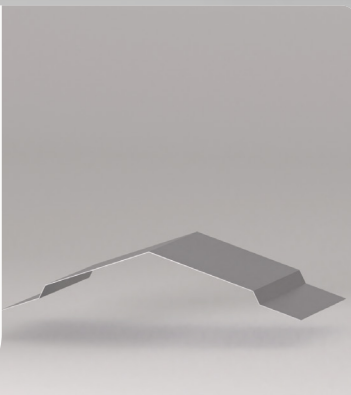
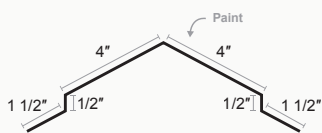

Standing Seam Locking Ridge Cap

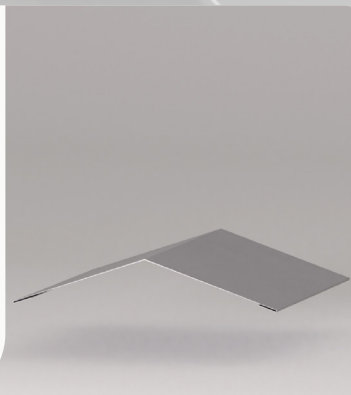
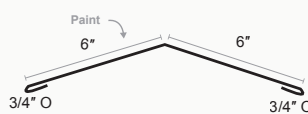

Standing Seam Ridge Valley

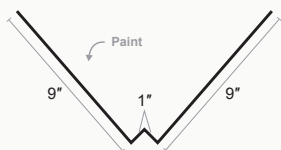

Paint

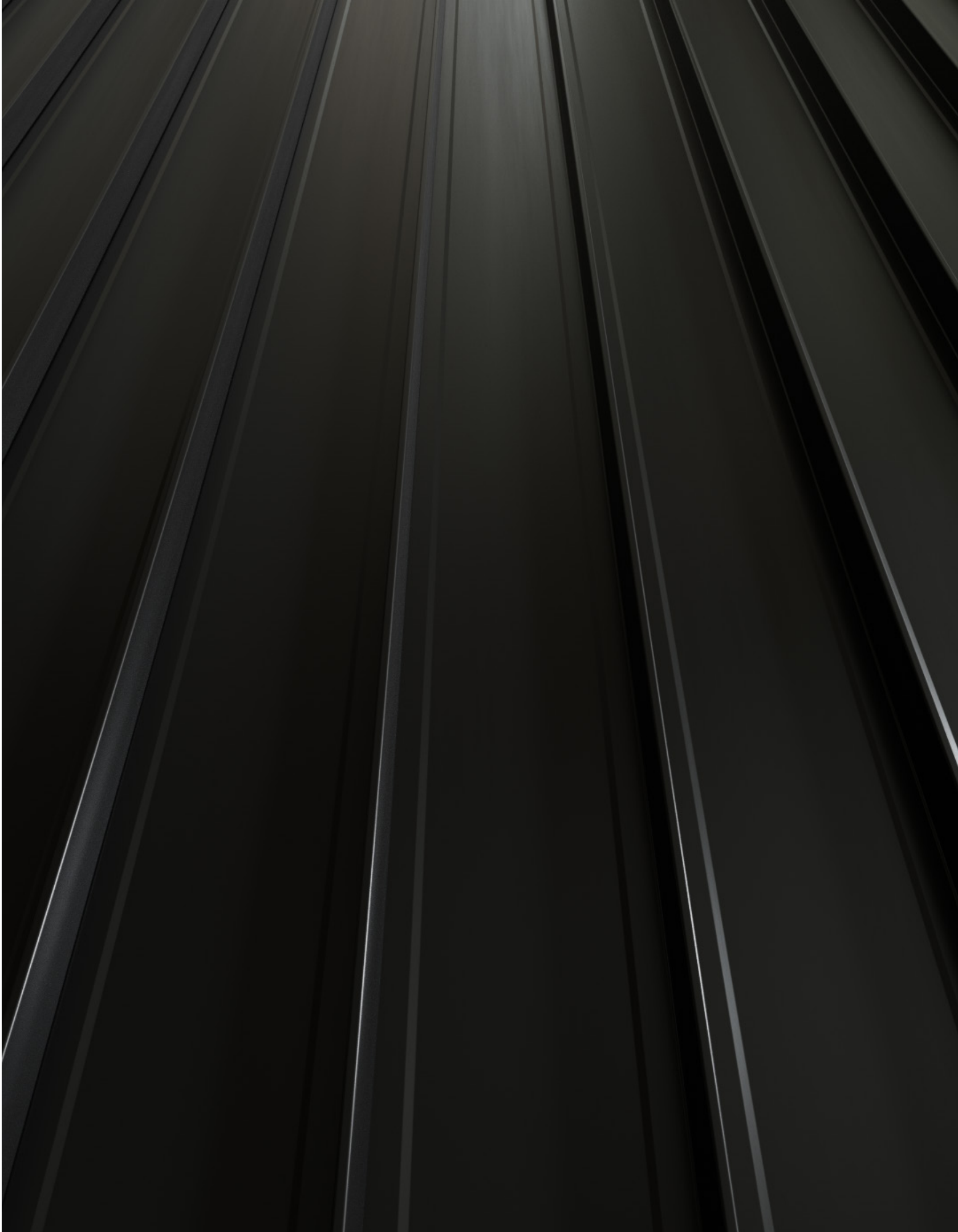



Metal America[®]
Roofing & Siding