



Metal America[®]
Roofing & Siding

Trim Profiles —

MECHANICALLY SEAMED

Standing Seam Locking Ridge Cap

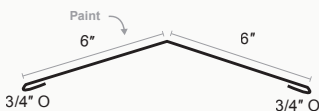

Standing Seam Locking Gable

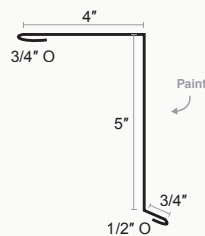

1-855-METALUS
(638-2587)

WWW.METALAMERICA.COM

SALES@METALAMERICA.COM

Mechanically Seamed

Locking Outside Corner

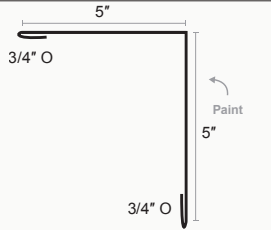

Locking Inside Corner

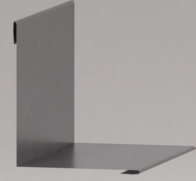
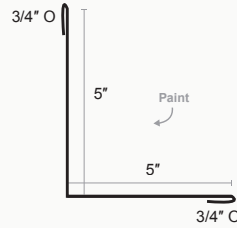

Eave Flashing

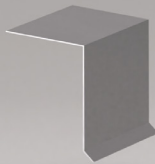
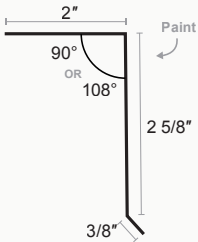

Style G Drip

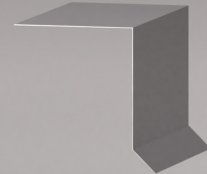
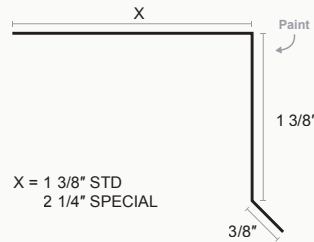

Bull Nose Eave

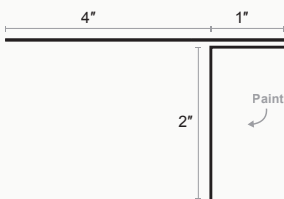

Style D

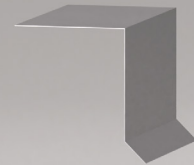
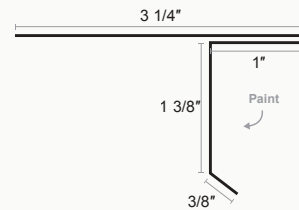

Custom Eave

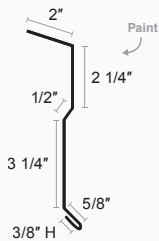

Drip Flashing

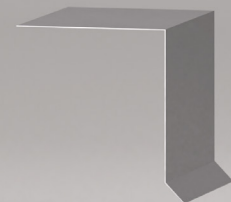
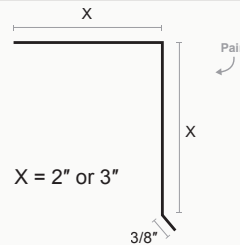

Mechanically Seamed

Standing Seam Locking Peak Cap

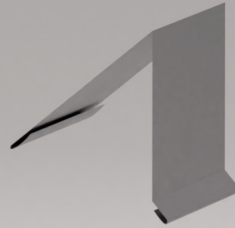
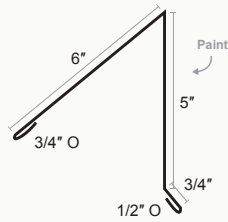

Fascia Trim

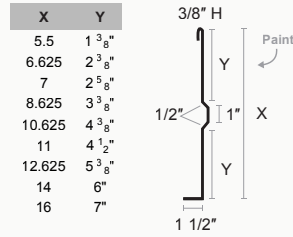

Standing Seam Side Wall

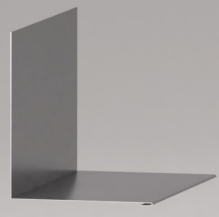
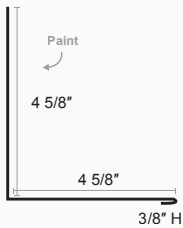

Locking Side Wall Flashing

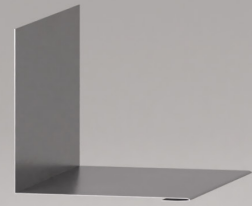
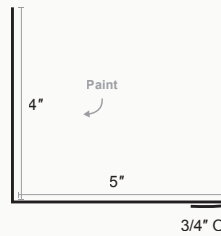

Standing Seam Box Gable

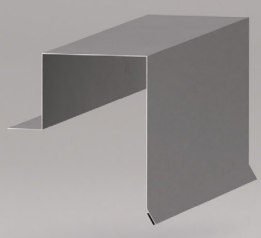
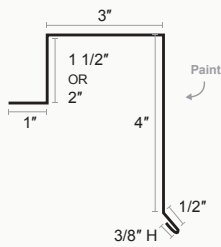

Standing Seam End Wall



Locking End Wall Flashing

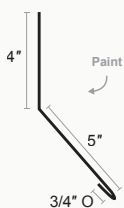

Open Jamb

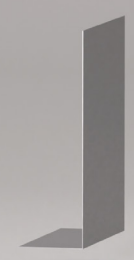
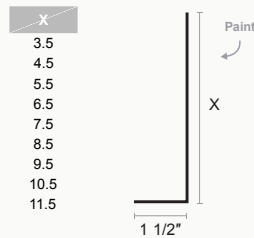

Mechanically Seamed

Standing Seam Raised Cleat



Offset Cleat

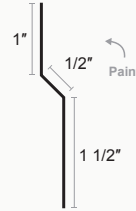

Standing Seam Ridge Valley

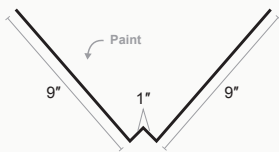

Z Bar

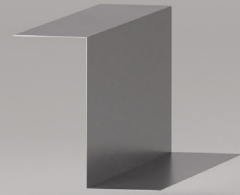
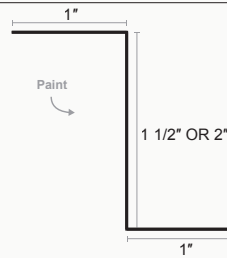

Standing Seam Locking Pitch Break

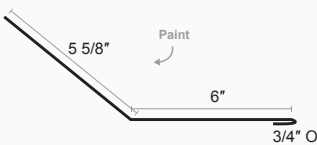

Standing Seam Locking Pitch Break Reverse

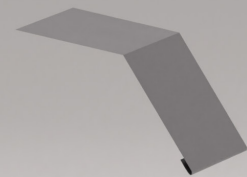
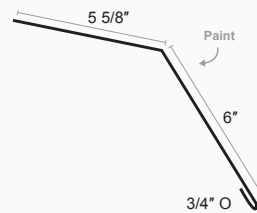

Chimney Flashing

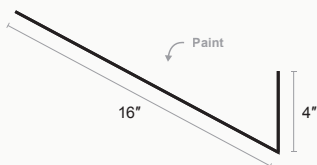

SnapZ Vented Z Bar

